

Backstage Livingroom



01_Visionnaire Salone del Mobile 019_1177

Backstage Livingroom



02_Visionnaire Salone del Mobile 019_1030

Backstage Livingroom



03_Visionnaire Salone del Mobile 019_1028

Backstage Livingroom



04_Visionnaire Salone del Mobile 019_1058

Backstage Livingroom



05_Visionnaire Salone del Mobile 019_1123

Backstage Livingroom



06_Visionnaire Salone del Mobile 019_1055

Backstage Livingroom



07_Visionnaire Salone del Mobile 019_1038

Backstage Livingroom



08_Visionnaire Salone del Mobile 019_1140

Backstage Livingroom



09_Visionnaire Salone del Mobile 019_1153

Backstage Livingroom



10_Visionnaire Salone del Mobile 019_1150

Backstage Livingroom



11_Visionnaire Salone del Mobile 019_1142

Backstage Livingroom



12_Visionnaire Salone del Mobile 019_1148

Backstage Livingroom



13_Visionnaire Salone del Mobile 019_1163

Backstage Livingroom



14_Visionnaire Salone del Mobile 019_1158

Backstage Livingroom



15_Visionnaire Salone del Mobile 019_1171

Backstage Livingroom



16_Visionnaire Salone del Mobile 019_1185

Backstage Livingroom



17_Visionnaire Salone del Mobile 019_1188

Backstage Livingroom



18_Visionnaire Salone del Mobile 019_1255

Backstage Livingroom



19_Visionnaire Salone del Mobile 019_1256

Backstage Livingroom



20_Visionnaire Salone del Mobile 019_1264

Backstage Livingroom



21_Visionnaire Salone del Mobile 019_1288

Backstage Livingroom



22_Visionnaire Salone del Mobile 019_1293

Backstage Livingroom



23_Visionnaire Salone del Mobile 019_1302

Backstage Livingroom



24_Visionnaire Salone del Mobile 019_1270

Backstage Livingroom



25_Visionnaire Salone del Mobile 019_1317

Backstage Livingroom



26_Visionnaire Salone del Mobile 019_1309

Backstage Livingroom



27_Visionnaire Salone del Mobile 019_1261

Backstage Livingroom



28_Visionnaire Salone del Mobile 019_1324

Backstage Livingroom



29_Visionnaire Salone del Mobile 019_1329

Backstage Livingroom



30_Visionnaire Salone del Mobile 019_1246

Backstage Livingroom



31_Visionnaire Salone del Mobile 019_1339

Backstage Livingroom



32_Visionnaire Salone del Mobile 019_1343

Backstage Livingroom



33_Visionnaire Salone del Mobile 019_1348

Backstage Livingroom



34_Visionnaire Salone del Mobile 019_1391

Backstage Livingroom



35_Visionnaire Salone del Mobile 019_1403

Backstage Livingroom



36_Visionnaire Salone del Mobile 019_1192

Backstage Livingroom



37_Visionnaire Salone del Mobile 019_1332

Backstage Livingroom



38_Visionnaire Salone del Mobile 019_1215

Backstage Livingroom



39_Visionnaire Salone del Mobile 019_1252

Backstage Livingroom



40_Visionnaire Salone del Mobile 019_1220

Backstage Livingroom



41_Visionnaire Salone del Mobile 019_1244

Backstage Livingroom



42_Visionnaire Salone del Mobile 019_1365

Backstage Livingroom



43_Visionnaire Salone del Mobile 019_1233

Backstage Livingroom



44_Visionnaire Salone del Mobile 019_1241

Backstage Livingroom



45_Visionnaire Salone del Mobile 019_1238

Backstage Livingroom



46_Visionnaire Salone del Mobile 019_1202

Backstage Livingroom



47_Visionnaire Salone del Mobile 019_1209

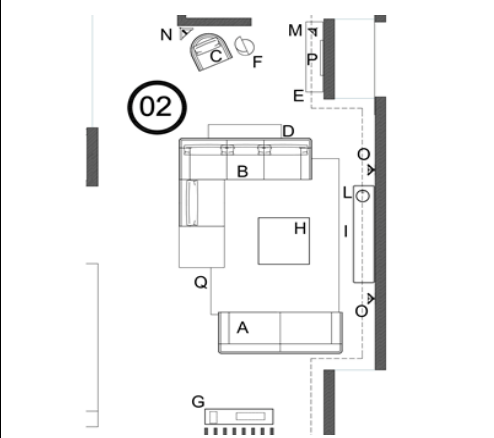
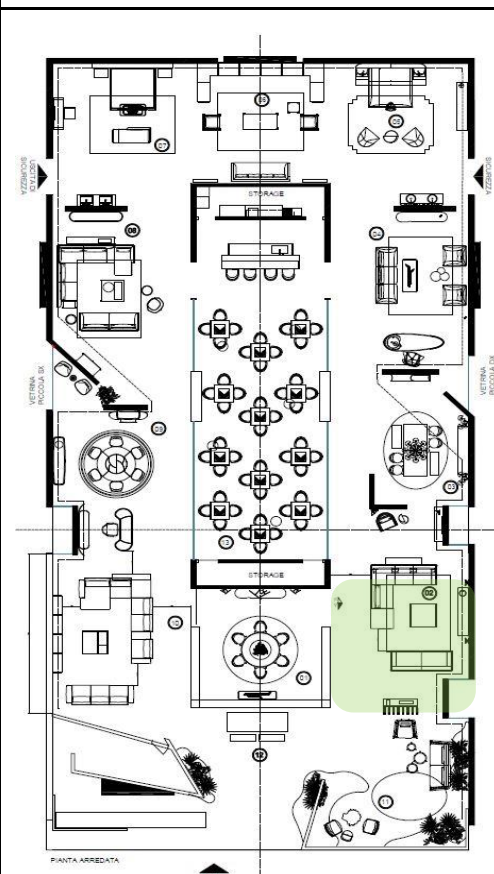

N°	Model	Description	Qty
A	BACKSTAGE	<p>Sofa cm 290x106 H. 65 External structure upholstered in interwoven leather Tepic 24280/91 Talpa Seat and back cushions upholstered in Soft Leather 1193 Ostrica; piping in Soft Leather 1194 Segale</p> <p>Base and steel profiles in black nickle lacquered satinized steel</p> <p>ALTERNATIVE VERSION - Eu 23.361,00 Sofa cm 290x106 H. 65 External structure upholstered in interwoven leather Madras 24301 Seat and back cushions upholstered in Soft Leather 1193 Ostrica; piping in Soft Leather 1194 Segale</p> <p>Base and steel profiles in black nickle lacquered satinized steel</p>	1
B	BACKSTAGE	<p>Modular composition: Sofa cm 310x106 H.65 cm (Euro. 26.221) Central element cm 120x106 H.65 (BSCW4) (Euro 9.447) Pouff cm 106X106 H. 40 (Euro 5.507) External structure upholstered in interwoven leather Tepic 24280/91 Talpa Seat and back cushions in fabric Impero 24300/01 Panna; piping in Soft Leather 1194 Segale Base and profiles in black nickle lacquered satinized steel Additional cushion for armrest/backrest cm 60x45 upholstered in Impero 24300/01 Panna; piping in leather Soft 1194 Segale.</p> <p>Loose cushion cm 40x40 upholstered in fabric Fontaine 24217/01 Madreperla Loose cushion cm 45x45 upholstered in fabric Brasilia 24264/02 Tortora Loose cushion cm 55x55 upholstered in Doppler 24252/900 Petrolio - Piping in Soft Leather 1194 Segale</p> <p>ALTERNATIVE VERSION (without loose cushions) - Eu 39.316,00 Modular composition: Sofa cm 310x106 H.65 cm (Euro 24.161) Central element cm 120x106 H.65 (BSCW4) - (Euro 9.068) Pouff cm 106X106 H. 40 (Euro 5.507) External structure upholstered in interwoven leather Madras 24301 Seat and back cushions in fabric Impero 24300/01 Panna; piping in Soft Leather 1194 Segale Base and profiles in black nickle lacquered satinized steel Additional cushion for armrest/backrest cm 60x45 upholstered in Impero 24300/01 Panna; piping in leather Soft 1194 Segale (Euro 580)</p>	1
			1
			2
			3
			1

N°	Model	Description	Qty
C	BACKSTAGE	Curved armchair cm 85 x 85 H 65 cm External structure upholstered in interwoven leather Madras 24301/13 Terra Seat and internal structure in leather Nabuk Maestrale 24127/3405 Tartufo; piping in Soft leather 1196 Marmotta Back cushion upholstered in fabric Doppler 24252/800 Beige Base and profile in black nickle lacquered satinized steel	1
D	BANNER	Console cm 172x35 H. 65 (BSEL11) Base and profile in black nickle lacquered satinized steel Top in Elegant Dune marble. Drawer front in carved solid wood with C.001 Frassino open-pore finishing Veneered elements with C.001 Frassino open-pore finishing. Drawers internally upholstered in microfibre. Lower shelf in smoked crystal glass.	1
E	BANNER	Console cm 180x40 H. 95 (BSEL12) Base and profile in black nickle lacquered satinized steel Top in Fior di bosco marble Drawer front in carved solid wood with C.001 Frassino open-pore finishing Veneered elements with C.001 Frassino open-pore finishing. Drawers internally upholstered in microfibre. Lower shelf in smoked crystal glass.	1
F	CYBORG HIGH	Low table cm. 51x40 H.60 Top in Fior di Bosco marble Structure upholstered in Soft Leather 1193 Ostrica Base and profile in black nickle lacquered satinized steel	1
G	MARTY	Console in glass cm 160x40 H. 97 Two bases coated in bronze mirror glass with ribbed low-relief decoration. Top in smoked boxed crystal glass. Steel coating with black nickle lacquered satinized finishing.	1
H	MARTY	Low table cm 120x120 H. 42 a 3 basi. Base cm 80x20: structure covered in Elegant Dune marble, top coated in black nickle satinized steel; plinth with black nickle satinized finishing. Base cm 50x20: structure coated in black nickle satinized steel, top covered in marble Elegant Dune; plinth with black nickle satinized finishing. Base cm 27x27: structure coated in black nickle satinized steel, top covered in marble Elegant Dune; plinth with black nickle satinized finishing. Top in smoked boxed crystal glass.	1

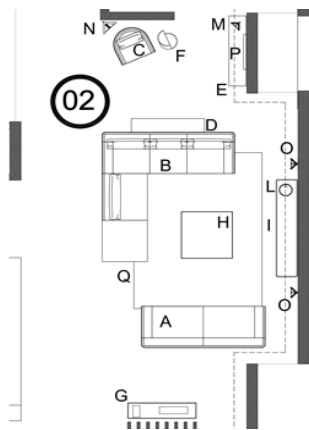

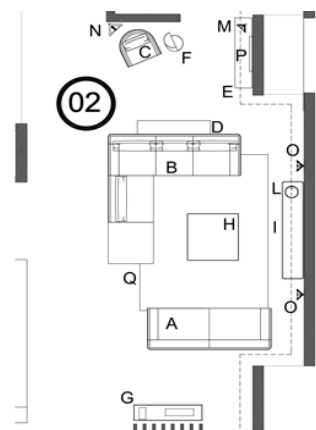

N°	Model	Description	Qty
I	PARKER	Low unit with 4 doors and 2 drawers cm 250x50 H. 74 Main structure covered in open-pore C. 001 veneered wood. Doors in low-relief carved wood with diamond pattern finished in open-pore C.001 veneered wood. Top marmo Elegant Dune Base and profiles in black nickle satinized steel. Internally lacquered in matt black. Rear back lacquered in matt black	1
L	OMEGA	Table lamp diam. cm 32 H. 50. Light diffuser in hand-cut glass with high thickness. Steel ring supported by two stems in black nickle satinized glass. Base in Calacatta Gold marble.	1
M	MOON-EYE	Table lamp Mini cm. 28x16 H. 40 Main structure in open-pore Canaletto walnut solid wood. Light diffuser in Patagonia Quartz. Black nickle satinized metal details.	1
M	MOON-EYE	lampada da tavolo Big cm. 42x23 H. 50 Main structure in open-pore Canaletto walnut solid wood. Light diffuser in Patagonia Quartz. Black nickle satinized metal details.	1
N	MOON-EYE	Floor lamp cm. 42x41 H. 150 Main structure in open-pore Canaletto walnut solid wood. Light diffuser in Patagonia Quartz. Black nickle satinized metal details. Base in Patagonia Quartz marble.	1
O	MOON-EYE	Wall lamp cm. 42x25 H. 50 Main structure in open-pore Canaletto walnut solid wood. Light diffuser in Patagonia Quartz. Black nickle satinized metal details.	2
P	POLIDORO	Mirror cm 90x160 Composite frame in Fior di Bosco and Arabescato Orobico Grigio marble. Structure in black nickle satinized steel; plate engraved with Visionnaire logo. Bevelled mirror	1
Q	CONWAY	Carpet cm. 300x400	1



HALL 5 - SALONE DEL MOBILE MILANO 2018
Pricelist

	N°	Model	Description	Qty
			TOTAL ROOM 2	